

BUNGE PARTITION

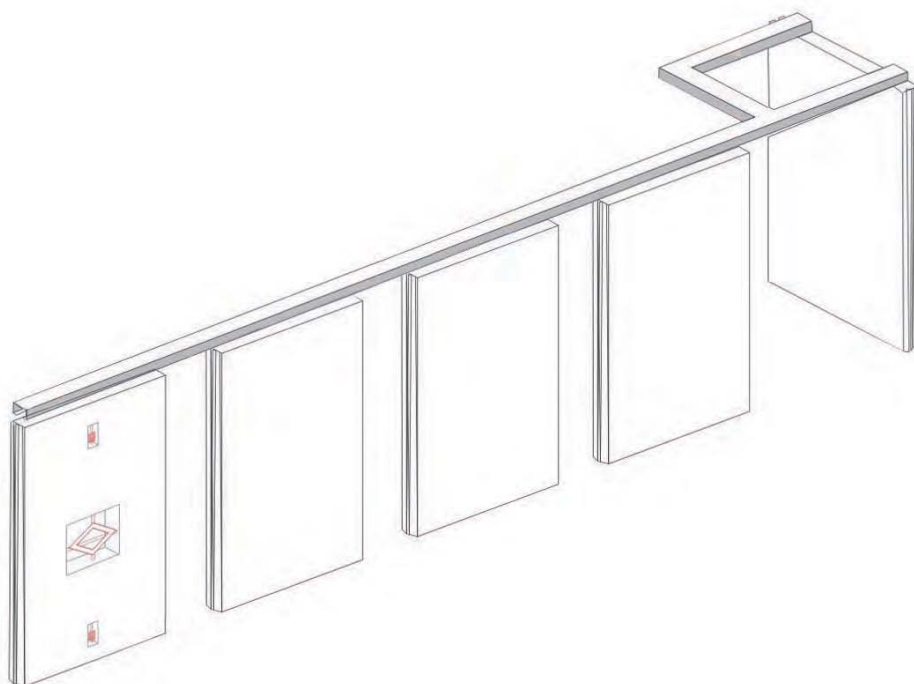

Guangdong Bunge Building Material Industrial Co., Ltd.

Tel: (+86) 020-81718567 (+86)15899953127

Fax: (+86) 020-81717767

Web: www.acoustic-partition.com

Add: No.490,Longxi Road,Liwan District,Guangzhou,China.



**Sound Proof Partition Walls Create Flexible Space
Movable Acoustic Walls & Operable Partition Walls**

About Us

COMPANY PROFILE



Guangdong Bunge Building Material Industrial Co.,Ltd is a professional company in manufacturing Movable Partitions. It also artistically designs and carefully does research and development (R&D). The company has adopted the advance partition technology of USA, Germany and Denmark. We have professional staffs with more than 10 years of experience in design, production and installation.

Our product (Movable Partition) are widely used in the hotel banquet hall, meeting room, exhibition hall, conference room, International Convention Center, KTV, upscale restaurants, office building, school, hospitals and others.

Nowadays, the modern trend in buildings needs more flexibility and convenience to use the space of their rooms. Most of the building designers like to prepare open plan space, sound proof effect, and easy to operate. The solution of the designers need is the Movable Partition.

Bunge Movable Partition Products as follow:

1. Ordinary Series: 65MM, 85MM;
2. High Sound Proof Series: 85MM, 100MM;
3. Super High Series: Steel Track System
4. Glass Series: 65MM & 85MM Aluminum Frame.



Effect Drawing

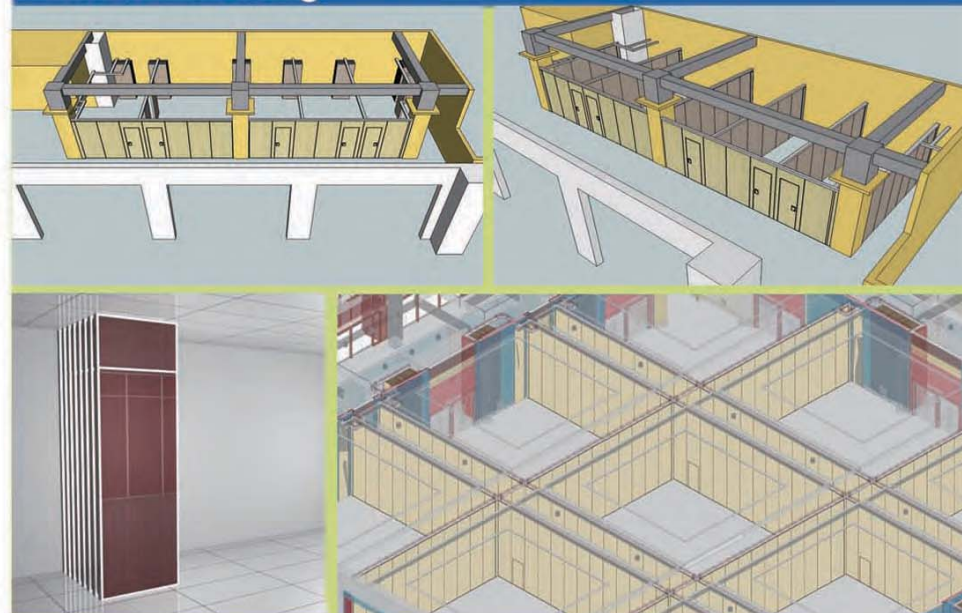

Movable Partitions

Series 65 | 80 | 85



Design

The operable wall series is the highest specification range of fully operable, individual-panel partition system. Acoustic insulation of up to 55dB noise reduction is achieved with a combination of operable top and bottom seals, high performance multiple infills and a panel assembly design that allows an acoustic break between the frame and outer layer. The vertical channels of each panel incorporate polymer inserts that facilitate an acoustic seal when the panels are set out as a wall. Panels are produced in four thicknesses, 65mm, 80mm, 85mm, and 100mm, depending on acoustic rating (from 32dB–55dB).



Soft Surface with Leather Covers



MDF with Melamine Finished

Partition Walls



Soft Surface with Fabric Covers & Melamine



MDF with Melamine Surface

Operation

When the operable seals are retracted, panels glide effortlessly and quietly along the unique aluminum overhead ceiling track system (no need for floor guide). Telescopic end panels enable the wall to be locked off to complete the acoustic seal. The track and carrier system provides ease of operation and directional flexibility, allowing panel stacking in countless configurations.



Operable Walls

Series 65 | 80 | 85

Key Features & Benefits

- ◆ Individual panels that can be stored away for maximum space usage.
- ◆ Operable top and bottom seals for effortless operation.
- ◆ Aluminum frame construction for enhanced acoustics.
- ◆ The system offers various levels of sound reduction
- ◆ Unique track and carrier system ensuring quiet and easy operation.
- ◆ Numerous panel stacking options for complete flexibility.
- ◆ Top hanging and no floor track.
- ◆ Extensive range of surface finishes can be available.



MDF with Melamine Surface



Hard Surface with Leather Covers

Folded Partitions

Applications

The panel is a range of folding wall systems that incorporates two panels (each up to 900mm wide) that are hinged together to give a flush appearance when closed.

Folding walls are quick to operate and are available in a range of acoustic ratings from 30dB – 49dB. Sound attenuation is achieved by modern manufacturing methods and the unique panel construction that consists of an aluminum frame, particleboard cladding and multiple acoustic infills.

Features & Benefits

- ◆ Hinged pair panels for quick and easy operation
- ◆ Robust aluminum frame construction for demanding environments
- ◆ Wide range of surface finishes
- ◆ Partial and fully glazed panels available
- ◆ Top hung supported



Folded with Fabric Soft Covers

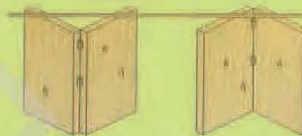

Series 100 Movable Walls

Key Features & Benefits

- ◆ Partition thickness: 100mm
- ◆ All frames adopt aluminum alloy # 6063-T6
- ◆ Height can reach 16m
- ◆ Sound insulation coefficient: 55db
- ◆ Retracted range of retracted panel: 150mm
- ◆ Apply to large exhibition Center, gym, etc.

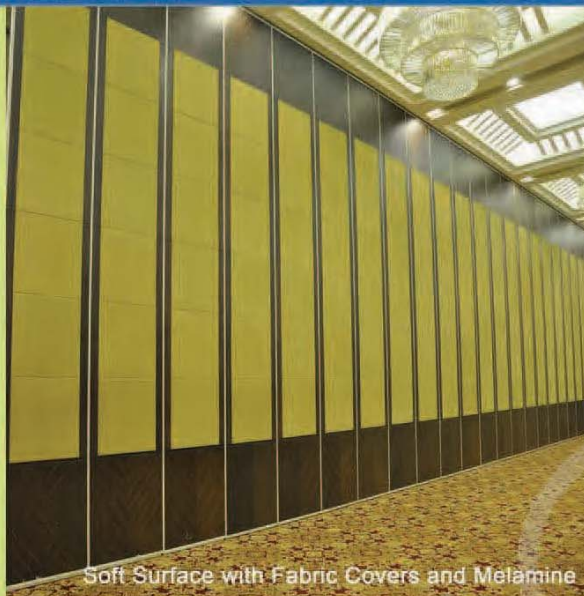

Soft Surface with Fabric Covers and Melamine



Wall paper covers

Meeting Room Partitions



MDF with Melamine Surface

The effective division of space some times requires utmost flexibility. Whether the requirement is to divide a teaching area, temporarily partition a conference suite, or simply create extra rooms out of one large space, the answer is movable walls. Movable walls, operable walls, sliding folding partitions

Alongside Bunge operable walls, the products also include, hinged partitions and concertina folding partitions along with a range of glass movable walls and industrial doors. Bunge provides unrivalled experience in the design and manufacture of space utilisation products.



Hard Surface with Fabric Covers

Ultra-High Movable Walls

- ◆ Ultra-high movable partitions are applied to the space as high as 7m to 16m, with maximum noise insulation effect of 55 decibels.
- ◆ Each meter of aluminium rail can load weight 2000 kg; the bearing capacity of each pulley is more than 1600 kg; it is commonly used in large banquet halls, large multi-function halls, exhibition centers, gymnasiums, auditoriums, and other large and tall establishments.
- ◆ The hanging system is developed and produced by using high-technologies.
- ◆ The hanging wheels slide smoothly on rails without vibration.
- ◆ The 16m high partition can be easily moved even being pushed at the bottom.
- ◆ The turning split mouth adopts specially designed steel plates, with a built-in orientation device.
- ◆ When the partition passes the turning split mouth, it will make a turn automatically following the orientation device, as if it is sliding on a straight rail.



Pass Door

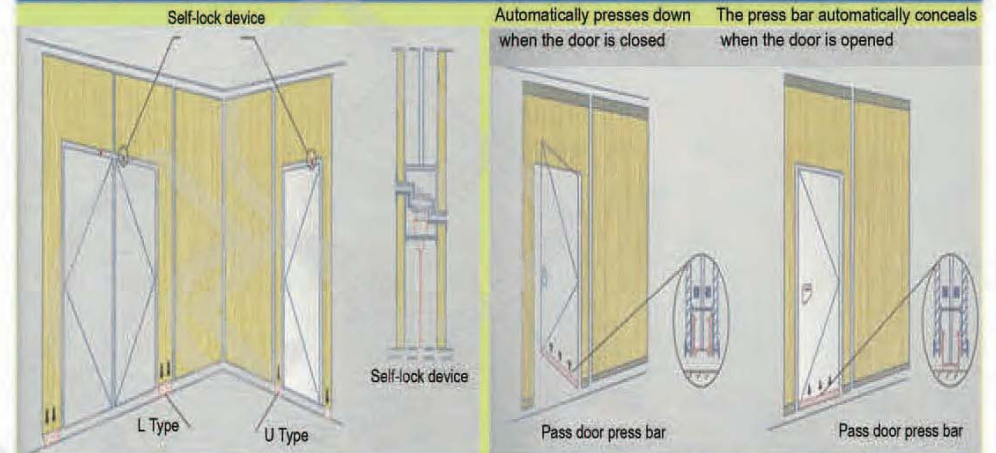

Pass door self-lock system

Using strong force spring press device to fix the pass door (door-in-door) instead of the fixing method with ground spike that can destroy the land



Movable Glass Partitions

Applications

The partition system provides the perfect solution for storefronts, restaurants and office environments where transparent space utilisation is the key requirement. It comprises of toughened glass panels secured in top and bottom profile elements which glide smoothly along an overhead track system.

The partition system is available in movable, folding, fixed and sliding glass walls configurations.

Operation

Stacking areas can be incorporated to enable panels to be stored away when the space needs to be opened up for access. There are no floor tracks or guides ensuring a clear threshold, free of dirt traps and obstructions.

Doors can be incorporated at virtually any point along the partition and can be either single or double acting.

The unique locking mechanism ensures that there is minimal hardware used, ensuring a smooth panel appearance.

The system is fully secured by either mechanical operated locking mechanisms.

Finishes

Aluminium frame with glass;
Top and bottom clip with glass.

Glass

Tempered safety glass 9mm., 10mm or 12mm
Tempered / laminated 5+5 mm, or 5+6mm



Sound Proof Glass Partitions



Aluminum Frame Glass Partition

Glazing Glass Partition

Features & Benefits

1. Top hung without the need for a floor track.
2. Panels with top and bottom glazing clip.
3. Smooth and easy operation, Panels are moved individually
4. Panels height less than 3000mm(118 inches)
5. Panels may be parked away from opening.
6. Between each piece of panel with transparent tape so that improve sound insulation and anti-collision function
7. Widely used in large office, shopping mall, restaurant, sunlight room and other places.



Glazing Clip Glas Partition



Glazing Clip Glass Door

Product Selection

Bunge Operable Wall Systems-Technical Information

Series	BG65	BG80 / BG85	BG100 & BG125
Panel suspension	Top hung only	Top hung only	Top hung only
Track system	Single or twin point	Single or twin point	Single or twin point
Panel thickness	65mm	80mm / 85mm	100mm
Panel height	Up to 4000mm	Up to 6000mm	Up to 18000mm
Max height	4000mm	6000mm	18000mm
Panel width	600-1230mm	600-1230mm	600-1230mm
Frame construction	Aluminum frame	Aluminum frame	Aluminum frame
Face material	9mm	9mm / 12mm	12mm
Fire safety	Optional Class I or O	Optional Class I or O	Optional Class I or O
Vertical profiles	Aluminum anodised with sealing profiles	Aluminum anodised with sealing profiles	Aluminum anodised with sealing profiles
Retractable seals	Aluminum black with double rubber seals	Aluminum black with double rubber seals	Aluminum black with double rubber seals
Operation of seals	Manual, with supplied operating handle	Manual, with supplied operating handle	Manual, with supplied operating handle
Locking	Optional lock to pass doors	Optional lock to pass doors	Optional lock to pass doors
Pass doors	Single open in panel or double open in two panel	Single open in panel or double open in two panel	Single open in panel or double open in two panel
Sound insulation	32-38dB Rw	36-45dB Rw	42-55dB Rw
Weight	Approx 22-35kg/sq M	Approx 25-40kg/sq M	Approx 30-48kg/sq M

Bunge Glass Partition Systems-Technical Information

Series	BG65 Glazing Glass Partition	BG85 Aluminum Frame Glass Partition	BG85 Sound proof Glass Partition
Panel suspension	Top hung only	Top hung only	Top hung only
Track system	Single or twin point	Single or twin point	Single or twin point
Panel thickness	36mm	85mm	85mm
Panel height	Up to 3000mm	Up to 6000mm	Up to 6000mm
Max height	3000mm	6000mm	6000mm
Panel width	800-1100mm	800-1100mm	800-1100mm
Frame construction	Top and bottom aluminum	Aluminum frame	Aluminum frame
Glass thickness	10mm single glass	10mm or 12mm single glass	double 10mm glass
Fire safety	Optional Class O	Optional Class O	Optional Class O
Vertical profiles	n/a	n/a	Aluminum anodised with sealing profiles
Retractable seals	n/a	n/a	Aluminum black with double rubber seals
Operation of seals	n/a	n/a	
Pass doors	Fixed full height door	Fixed full height door	Fixed full height door
Locking	Optional lock to panel	Optional lock to panel	Optional lock to panel
Sound insulation	n/a	n/a	n/a
Weight	Approx 30 kg/sq M	Approx 32 kg/sq M	Approx 50 kg/sq M

Panel Stacking

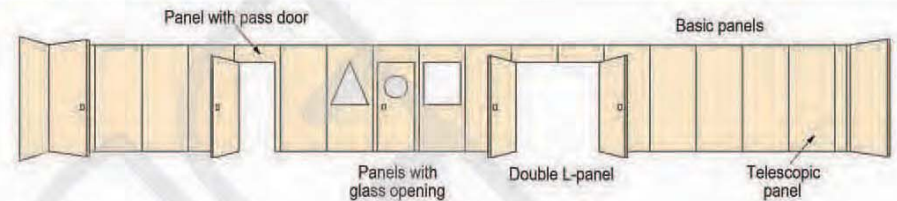

Panel Stacking Options

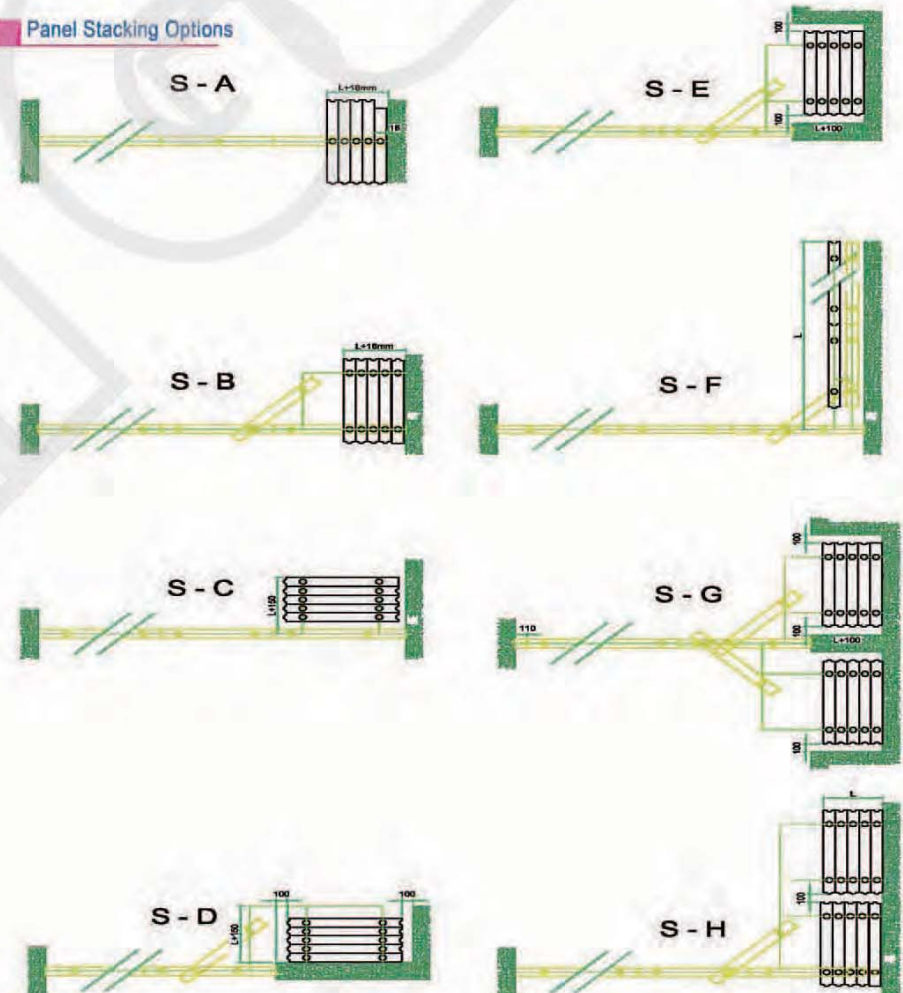

Operation

When moving a wall panel there is a 20-25mm gap between the top of the panel and the underside of the head track, there is a similar gap between the bottom of the panel and the floor.

Once a panel is positioned, acoustic integrity is maintained along the top and bottom of the panel by extending pressure seals. The pressure seals are extended and retracted by a single 180° turn of a removable operating handle.

Final closure of the wall is achieved by extending a telescopic sleeve on the last panel. This action simultaneously extends the top and bottom seals.



"M" & "W" Frame Seal Device

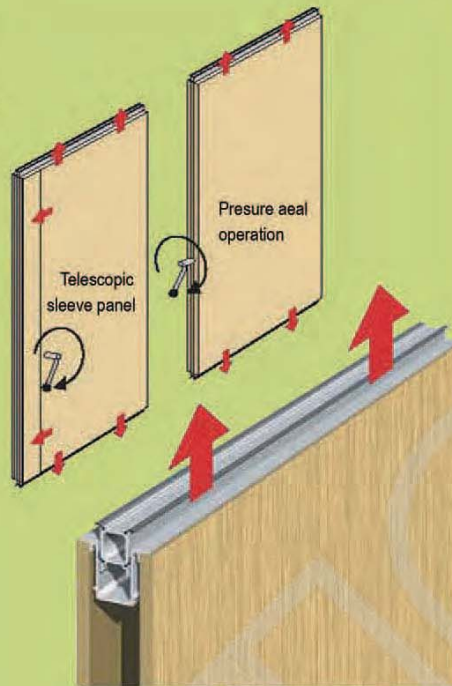

Hanging System



Track and Roller

These profiles are fitted with magnetic membranes which ensure positive interlocking of the panels. Once the wall panels have been adjusted for height and level the roller stems are locked with a fail-safe mechanism to ensure that the panels will align perfectly every time the wall is set up. Pressure seals extend from the top and bottom of each panel exerting a closing pressure of 2kg providing panel stability and excellent acoustic sealing.

Panel faces are suspended from a steel frame with just 1 or 2 points of contact. The edges of panel faces are slotted into aluminium profiles. This method of cladding the steel frame allows the panel faces to be acoustically separated from each other and thereby minimises the transfer of sound waves through the system. Each panel has an extruded aluminium male profile to one vertical edge and a female profile to the other.

Key Features & Benefits

- ◆ Individual panels that can be stored away for maximum space utilisation.
- ◆ Operable top and bottom seals for effortless operation.
- ◆ Isolated aluminium frame construction for enhanced acoustics.
- ◆ No floor track ensuring obstruction free threshold.
- ◆ Three panel sizes to accommodate a wide range of acoustic requirements.
- ◆ Extensive range of surface finishes can be applied.



Track of Collection Room



Exhibition Partition



Hotel Partitions

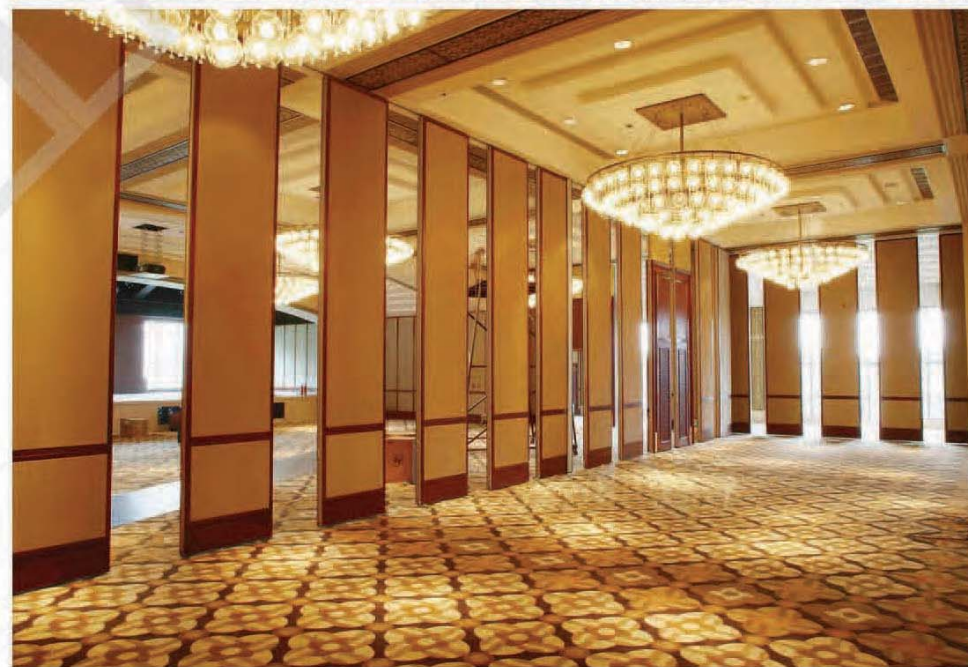

Aluminum Material



Straight Guide Track



Series65 Track



Series85 Track



Series100 Track



"W" Alumiseal



"M" Alumiseal



Aluminum Frame



Shaped Aluminum



Top and Bottom Aluminum



Depression bar



Combination



Telescopic Aluminum



Aluminum Strip



Pass Door Frame



Aluminum Glazing



Aluminum Glass Clip

Accessories



Material Description

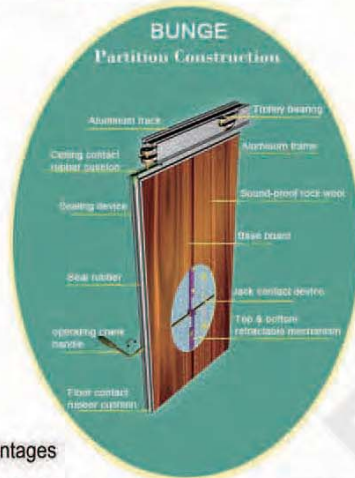

Bunge Movable Partition Wall Advantages

1. Bunge latest roller POM materials to meet its best wearing resistant, the high carbon chromium bearing steel has reach to a strength 10.9 grade.
2. Bunge's vertical crank handle shaft made by 304 stainless steel LCP panel crank handle shaft cup and operable handle.
3. Bunge double corrosion-resistant aluminum track systems are easy to install and easier to maintain. Extruding enable each section to have a uniform for superior end-to-end alignment. Each capacity-certified track is of extrude architectural grade clear anodized 6063-T6 aluminum.
4. The safety and stability of movable partition are effected by what kind of keel materials used inside in structure. Bunge use both the 6063-T6 aluminum keels and wood keels, keeps every two keels at a distance max no more than 600mm.
5. To seal the corner, Bunge gets its own design about specially developed conically shaped corner pieces that fit closely together. They ensure excellent soundproofing and stability.
6. Bunge's sweep seal are less expensive alternative to retract top seals. Sweep seal are multi-fingered vinyl seals that close the gap between the top of the panel and tracks. It really is an effective sound barrier for most applicant.
7. Bunge's vinyl seals are made of Nitrile Butadiene Rubber(NBR),durable and perfect for sound installation, and long time wearing.
8. ASTM international is an organize establish standards for testing and application in many areas including acoustics. Bunge designs and builds their acoustic operable partition systems including tracks, rollers, panels and doors according to the common ASTM standards of acoustic.

Partition Color Chart



Installation

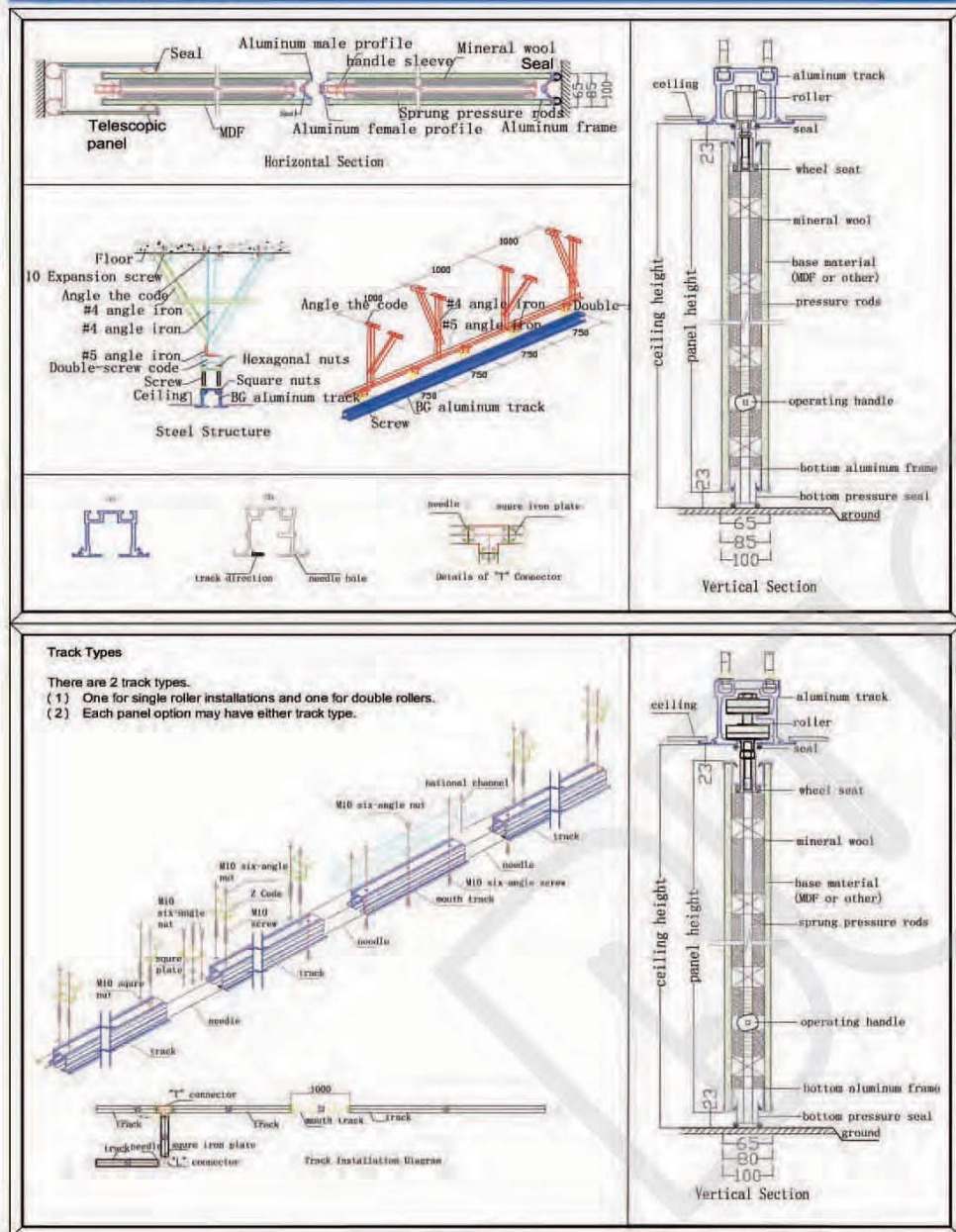

FAQ

1. How to select the suitable movable wall for your site?

We have 5 types of movable wall, 65type, 80type, 85type, 100type and 125 ultra-high type.

You can choose the right movable wall upon the Height and Soundproof requirement as following.

65type— Max height: 4000mm(160inch), Soundproof: 32dB to 43dB

80type— Max height: 5500mm(220inch), Soundproof: 38dB to 48dB

85type— Max height: 6000mm(240inch), Soundproof: 38dB to 50dB

100type— Max height: 9000mm(350inch), Soundproof: 42dB to 55dB

125ultra-height— Max height: 17000mm(670inch), Soundproof: 42dB to 55dB

2. What you should do on site?

A beam(truss) should be built on site for track installation. The minimum distance leaving for track installation from false ceiling to top ceiling is 180mm.

3. How to install?

We will provide the installation manual and video guiding the installation job. We can also dispatch the installation engineer supervising the installation as request.

4. What is lead time?

The lead time is 7 days to 10 days.

5. How to transport?

Sea transport is a common mode of transportation. In an emergency, can be air freight.

6. How do the goods packing?

Carton paper packaging, MDF batten cover all around corner.

The movable wall panel and track, fittings will be packed separately.

7. What is Procurement procedure?

◆ Firstly, send us the shop drawings(if the shop drawings is not available, you can tell us the height from false ceiling to finished floor and width from wall to wall).

◆ Secondly, we offer you the movable wall layout drawings for your confirmation.

◆ Thirdly, we quote the movable wall in accordance with confirmed drawings.

8. What is finishing surface?

◆ The bottom panel is MDF or plywood, which is unfinished face.

◆ You can do decoration on site, such as wallpaper, paint, etc.

◆ We can also provide the product with finished face, such as melamine, faux wood, Woven fabric and Leather.

◆ Choose from our stylish fabric or leather covers and have the option to have a soft / hard surface.

◆ We can also provide glass partition for glass clip or aluminium frame panel.